

### MINIMUM PRESSURE LOSS

Ball valves provide minimum pressure loss thanks to their straight through flow characteristics compared to other types of valves. In a full bore ball valve, the pressure loss is equal to friction loss in a pipe having the same nominal diameter and length of the valve .

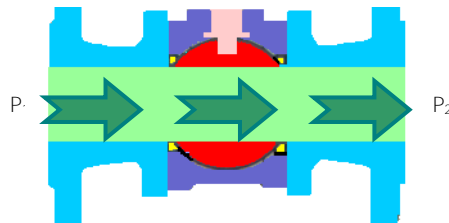

### EASY MAINTENANCE

Especially, in 3-pcs. construction screwed ball valves, since all moving and sealing parts are located in the intermediate piece called body, therefore maintenance can be made easily by disassembling stud bolts without removing end connections from the line and centering ears on the body of Valftek ball valves even make it easier to assemble and disassemble the valves.

### TOP FLANGE FOR ACTUATOR MOUNTING

To adapt ball valves into automation system, Valftek ball valves have top flanges acc. to ISO 5211 in standard enabling easy mounting of actuators without interfering the sealing system . Thanks to a compression nut under the handle for safety reason, packing sealing system is not influenced by removal of the handle in case of actuator mounting.

### REINFORCED BODY

Due to double sealing effect, fluid remaining between ball and body when the valve is in closed position may freeze under severe winter conditions or heated by high temperature fluid, resulting in high pressure accumulated inside the body. Such a situation may cause the body made of cast iron (JL1040) to crack. To avoid such an unfavourable situation, bodies of Valftek PN16 ball valves are made of spheroidal cast iron (JS1049) up to DN50 in standard.

**DOUBLE SEALING SYSTEM**

PTFE seat rings used in Valfttek ball valves make elastic displacement under fluid pressure and provide double sealing effect both on inlet and outlet sides .

- ❖ Valfttek ball valves have floating balls and the seat ring (1) at the inlet compresses on the ball and make a perfect sealing through the line even under low pressures .
- ❖ Additionally, as seen on the picture below, pressure acting on the ball when the valve is closed, pushes the ball on the seat ring (2) at the outlet and increases sealing performance.
- ❖ Furthermore, fluid pressure compressing on the seat ring (1) pushes the ring on the ball and together with the seat ring (2) presents double sealing effect.

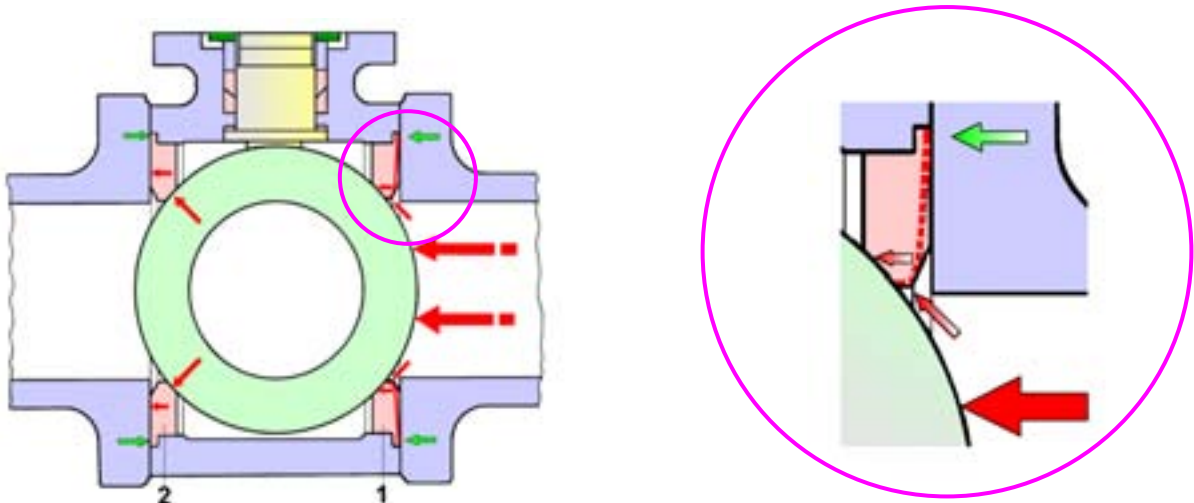

**PACKING SEALING SYSTEM**

Sealing to the atmosphere through the stem in Valfttek ball valves is achieved by means of "V" type PTFE packing rings .

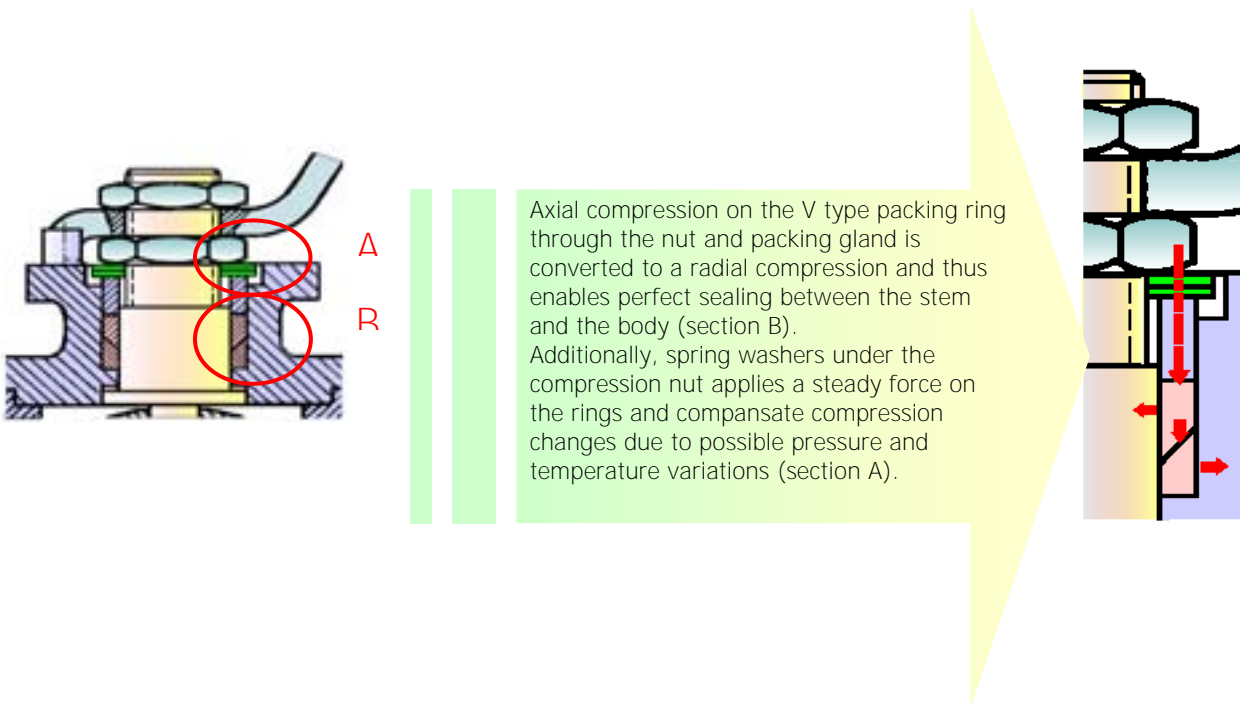

- Model** : VKV (Full bore)
- Pressure rating** : PN16 – PN40
- Connection** : Flanged to TS ISO 7005-2, DIN EN 1092-2
- Dimensions** : According to EN 558-1
- Applications** : Water, hot water, compressed air, gases, industrial fluids

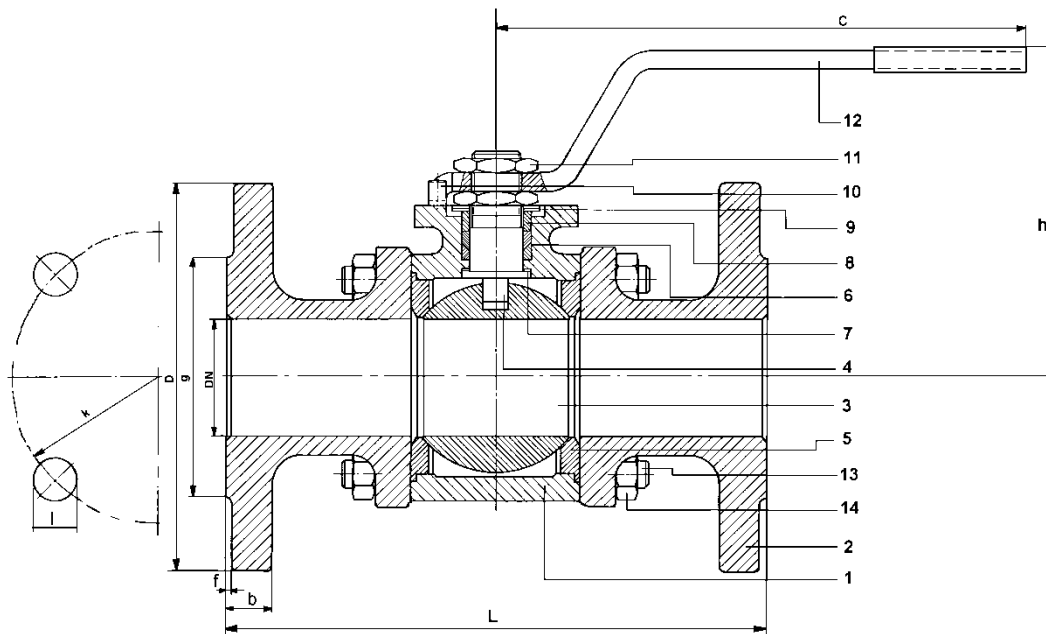

Part no/name	Material	
	PN16	PN40
1-Body	JS1049 (GGG-40.3)	JS1049 (GGG-40.3)
2-End cap	JL1040 (GG-25)	JS1049 (GGG-40.3)
3-Ball	1.4301/1.4086 Stainless steel	1.4301/1.4086 Stainless steel
4-Stem	1.4104 Stainless steel	1.4104 Stainless steel
5-Seat ring	PTFE	PTFE
6-Packing ring	PTFE	PTFE
7-Thrust washer	PTFE	PTFE
8-Packing gland	St 37	St 37
9-Spring washer	Ck 70	Ck 70
10-Retaining pin	St 37	St 37
11-Handle nut	5	5
12-Handle	St 42	St 42
13-Stud bolt	5.6	5.6
14-Nut	5	5

### FULL BORE VALVE DIMENSIONS PN16 – PN40

Size	Dimensions			Flange dimensions												Weight			
				PN16								PN40				PN16	PN40		
DN	L	h	c	D	b	k	l	n	g	f	D	b	k	l	n	g	f	Kg	Kg
15	130	81	135	95	14	65	14	4	46	2	95	16	65	14	4	46	2	2,2	2,3
20	150	95	160	105	16	75	14	4	56	2	105	18	75	14	4	56	2	3	3,2
25	160	100	160	115	16	85	14	4	65	3	115	18	85	14	4	65	3	3,9	4
32	180	128	200	140	18	100	19	4	76	3	140	18	100	19	4	76	3	6,5	6,5
40	200	135	200	150	18	110	19	4	84	3	150	18	110	19	4	84	3	7,7	8,1
50	230	139	285	165	20	125	19	4	99	3	165	20	125	19	4	99	3	10,5	12,7

Dimensions are in mm. We reserve the right to modify construction and material without notice .

- Model** : VKV (Full bore)
- Pressure rating** : PN16 – PN40
- Connection** : Flanged to TS ISO 7005-2, DIN EN 1092-2
- Dimensions** : According to EN 558-1
- Applications** : Water, hot water, compressed air, gases, industrial fluids

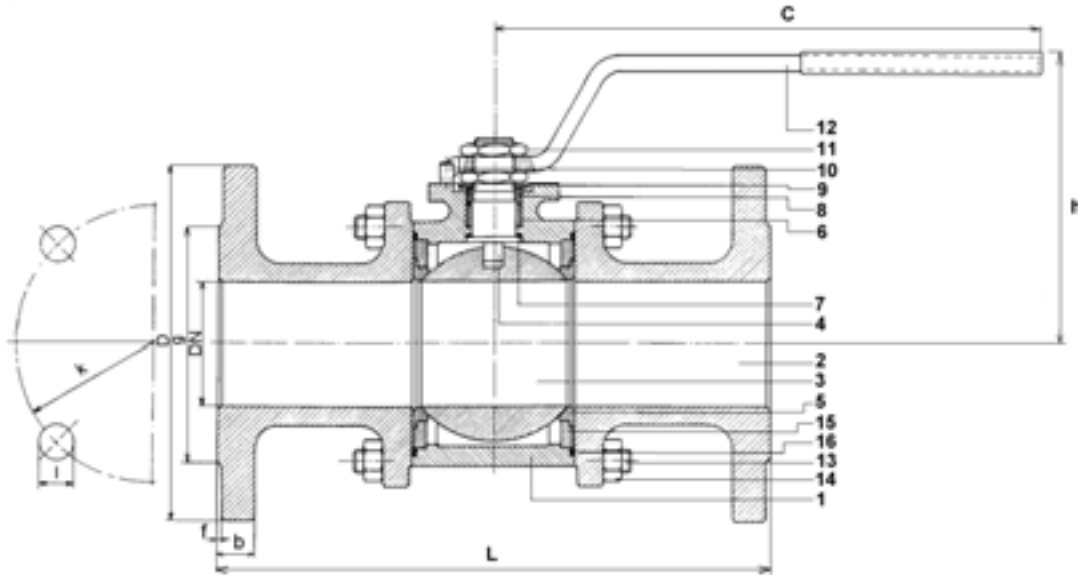

Part no/name.	Material	
	PN16	PN40
1-Body	JL1040 (GG-25)	JS1049 (GGG-40.3)
2-End cap	JL1040 (GG-25)	JS1049 (GGG-40.3)
3-Ball	1.4086 Stainless steel	1.4086 Stainless steel
4-Stem	1.4104 Stainless steel	1.4104 Stainless steel
5-Seat ring	PTFE	PTFE
6-Packing ring	PTFE	PTFE
7-Thrust washer	PTFE	PTFE
8-Packing gland	St.37	St.37
9-Spring washer	Ck70	Ck70
10-Retaining pin	St 37	St 37
11-Handle nut	5	5
12-Handle	St 42	St 42
13-Stud bolt	5.6	5.6
14-Nut	5	5
15-Support ring	JL 1030 (GG-20)	JL 1030 (GG20)
16-Body seal	PTFE	PTFE

### FULL BORE VALVE DIMENSIONS PN16 – PN40

Size	Dimensions			Flange dimensions												Weight			
				PN16						PN40						PN16	PN40		
DN	L	h	c	D	b	k	l	n	g	f	D	b	k	l	n	g	f	Kg	Kg
65	290	150	285	185	20	145	19	4	118	3	185	22	145	19	8	118	3	18,4	18,7
80	310	178	410	200	22	160	19	8	132	3	200	24	160	19	8	132	3	28,1	28,5
100	350	192	410	220	24	180	19	8	156	3	235	24	190	23	8	156	3	39	40

Dimensions are in mm. We reserve the right to modify construction and material without notice .

- Model** : VKV (Full bore)
- Pressure rating** : PN16 – PN25
- Connection** : Flanged to TS ISO 7005-2, DIN EN 1092-2
- Dimensions** : According to EN 558-1
- Applications** : Water, hot water, compressed air, gases, industrial fluids

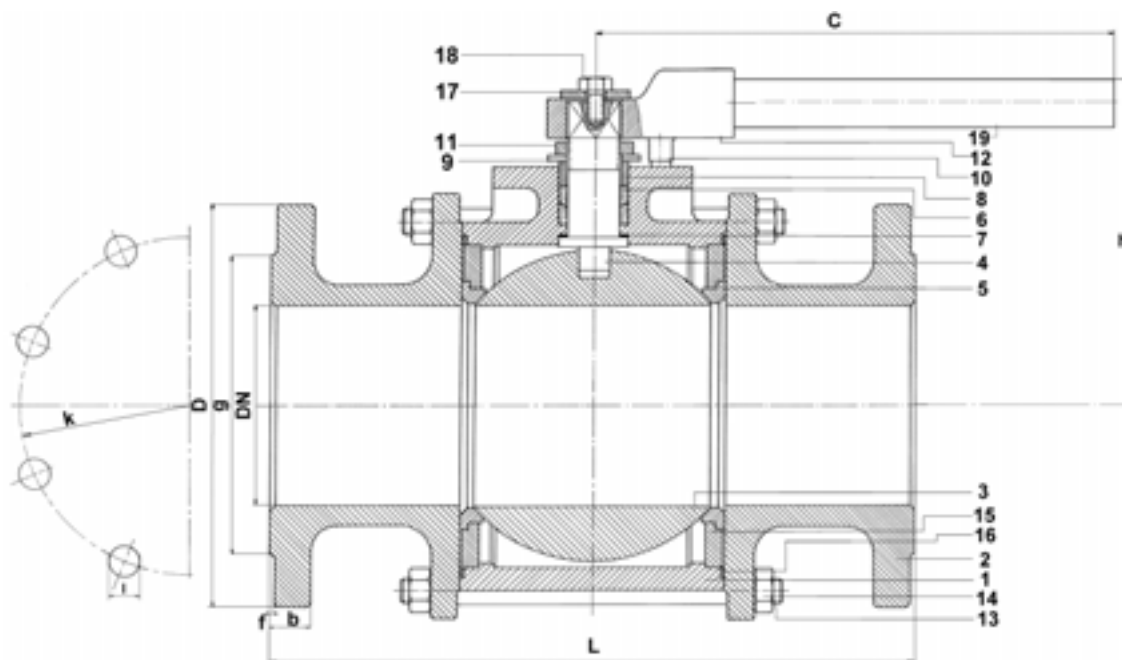

Part no/name	Material	
	PN16	PN25
1-Body	JL1040 (GG-25)	JS1049 (GGG-40.3)
2-End cap	JL1040 (GG-25)	JS1049 (GGG-40.3)
3-Ball	1.4086 Stainless steel	1.4086 Stainless steel
4-Stem	1.4104 Stainless steel	1.4104 Stainless steel
5-Seat ring	PTFE	PTFE
6-Packing ring	PTFE	PTFE
7-Thrust washer	PTFE	PTFE
8-Packing gland	St.37	St.37
9-Spring washer	Ck70	Ck70
10-Retaining pin	St 37	St 37
11-Handle nut	5	5
12-Handle adaptor	JS 1049 (GGG-40.3)	JS 1049 (GGG-40.3)
13-Stud bolt	5.6	5.6
14-Nut	5	5
15-Support ring	JL 1030 (GG-20)	JL 1030 (GG-20)
16-Body seal	PTFE	PTFE
17-Washer	St 37	St 37
18-Bolt	5.6	5.6
19-Handle	St 42	St 42

### FULL BORE VALVE DIMENSIONS PN16 – PN25

Size	Dimensions				Flange dimensions														Weight	
	PN16		PN25		PN16							PN25							PN16	PN25
	L	L	h	c	D	b	k	l	n	g	f	D	b	k	l	n	g	f	Kg	Kg
DN 125	400	400	210	660	250	26	210	19	8	184	3	270	26	220	28	8	184	3	60,1	70
DN 150	350	450	230	695	285	26	240	23	8	211	3	300	28	250	28	8	211	3	79,4	89
DN 200	400	550	275	905	340	30	295	23	12	266	3	360	30	310	28	12	274	3	142,3	165

Dimensions are in mm. We reserve the right to modify construction and material without notice .

- Model** : VKV (Full bore) –Trunnion mounted ball
- Pressure rating** : PN16 – PN25
- Connection** : Flanged to TS ISO 7005-2, DIN EN 1092-2
- Dimensions** : According to EN 558-1
- Applications** : Water, hot water, compressed air, gases, industrial fluids

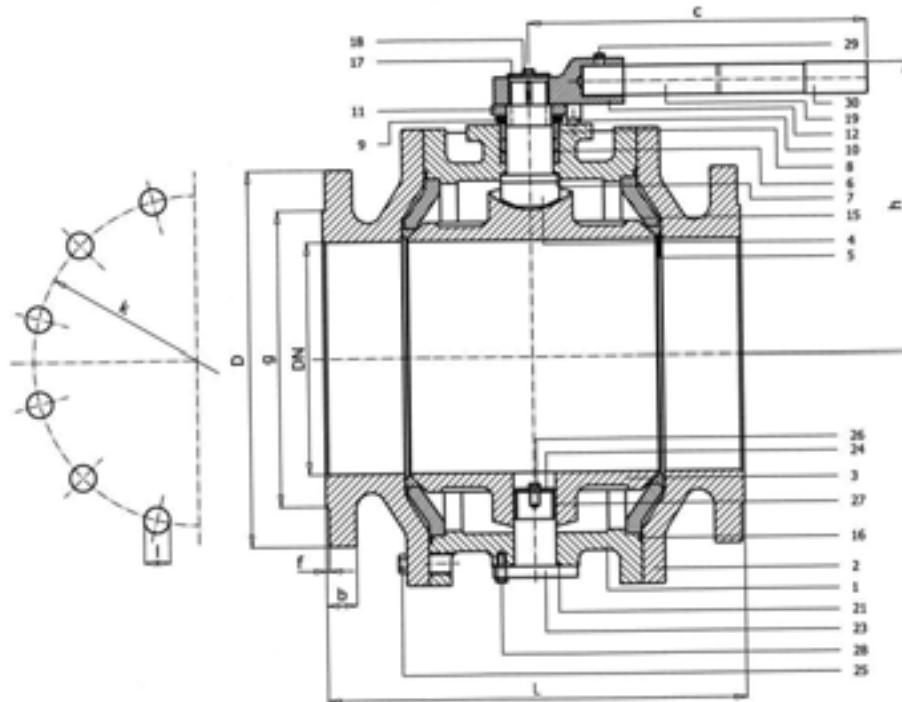

Part no/name	Material	
	PN16	PN25
1-Body	JL1040 (GG-25)	JS1049 (GGG40.3)
2-End cap	JL1040 (GG-25)	JS1049 (GGG40.3)
3-Ball	1.4086 SS	1.4086 SS
4-Stem	1.4104 SS	1.4104 SS
5-Seat ring	PTFE	PTFE
6-Packing ring	PTFE	PTFE
7-Thrust washer	PTFE	PTFE
8-Packing gland	St.37	St.37
9-Spring washer	Ck70	Ck70
10-Retaining pin	St 37	St 37
11-Lever nut	5	5
12-Handle adaptor	JS1049 (GGG40.3)	JS1049 (GGG40.3)
13-Stud bolt	5.6	5.6
14-Nut	5	5
15-Support ring	JL 1030 (GG-20)	JL 1030 (GG-20)
16-Body seal	PTFE	PTFE
17-Washer	St 37	St 37
18-Bolt	5,6	5,6
19-Handle	St 42	St 42
21-Gasket	Graphite	Graphite
23-Lower bearing stem	St42	St42
24-Washer	St37	St37
25-Bolt	8.8	8.8
26-Bolt	5.6	5.6
27-Sleeve ring	R-PTFE	R-PTFE
28-Bolt	5.6	5.6
29-Bolt	8.8	8.8
30-Handle cover	PVC	PVC

Dimensions are in mm. We reserve the right to modify construction and material without

### FULL BORE VALVE DIMENSIONS PN16

Size	Dimensions			Flange dimensions							Weight
	DN	L	h	c	D	b	k	l	n	g	
250	450	315	1060	405	32	355	28	12	319	3	238

### FULL BORE VALVE DIMENSIONS PN25

Size	Dimensions			Flange dimensions							Weight
	DN	L	h	c	D	b	k	l	n	g	
250	450	315	1060	405	32	355	28	12	319	3	238

- Model** : VKV (Reduced bore)
- Pressure rating** : PN16 – PN40
- Connections** : Flanged to TS ISO 7005-2, DIN EN 1092-2
- Dimensions** : According to EN 558-1
- Applications** : Water, hot water, compressed air, gases, industrial fluids

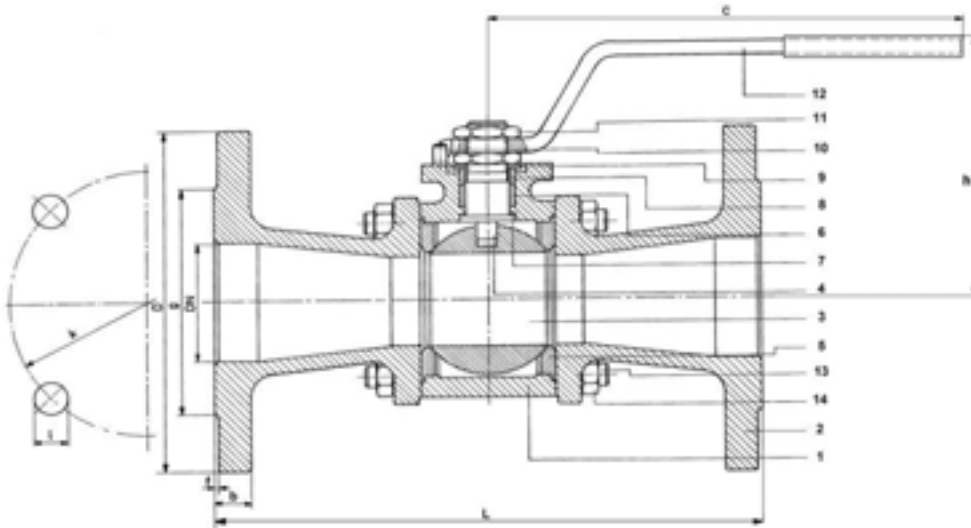

Part no/name	Material	
	PN16	PN40
1-Body	JS1049 (GGG-40.3)	JS1049 (GGG-40.3)
2-End cap	JL1040 (GG-25)	JS1049 (GGG-40.3)
3-Ball	1.4301/1.4086 Stainless steel	1.4301/1.4086 Stainless steel
4-Stem	1.4104 Stainless steel	1.4104 Stainless steel
5-Seat ring	PTFE	PTFE
6-Packing ring	PTFE	PTFE
7-Thrust washer	PTFE	PTFE
8-Packing gland	St.37	St.37
9-Spring washer	Ck 70	Ck 70
10-Retaining pin	St 37	St 37
11-Handle nut	5	5
12-Handle	St 42	St 42
13-Stud bolt	5.6	5.6
14-Nut	5	5

### REDUCED BORE VALVE DIMENSIONS PN16 – PN40

Size	Dimensions			Flange dimensions														Weight	
				PN16							PN40							PN16	PN40
DN	L	H	c	D	b	k	l	n	g	f	D	b	k	l	n	g	f	Kg	Kg
15/15	130	81	135	95	14	65	14	4	46	2	95	16	65	14	4	46	2	1,9	2,1
20/15	150	81	135	105	16	75	14	4	56	2	105	18	75	14	4	56	2	2,7	2,7
25/20	160	95	160	115	16	85	14	4	65	3	115	18	85	14	4	65	3	3,7	3,6
32/25	180	100	160	140	18	100	19	4	76	3	140	18	100	19	4	76	3	5,5	5,3
40/32	200	128	200	150	18	110	19	4	84	3	150	18	110	19	4	84	3	7,1	7
50/40	230	135	200	165	20	125	19	4	99	3	165	20	125	19	4	99	3	9,4	9,3
65/50	290	139	285	185	20	145	19	4	118	3	185	22	145	19	8	118	3	14,7	15,3

Dimensions are in mm. We reserve the right to modify construction and material without notice .

- Model** : VKV (Reduced bore)
- Pressure rating** : PN16 – PN40
- Connection** : Flanged to TS ISO 7005-2, DIN EN 1092-2
- Dimensions** : According to EN 558-1
- Applications** : Water, hot water, compressed air, gases, industrial fluids

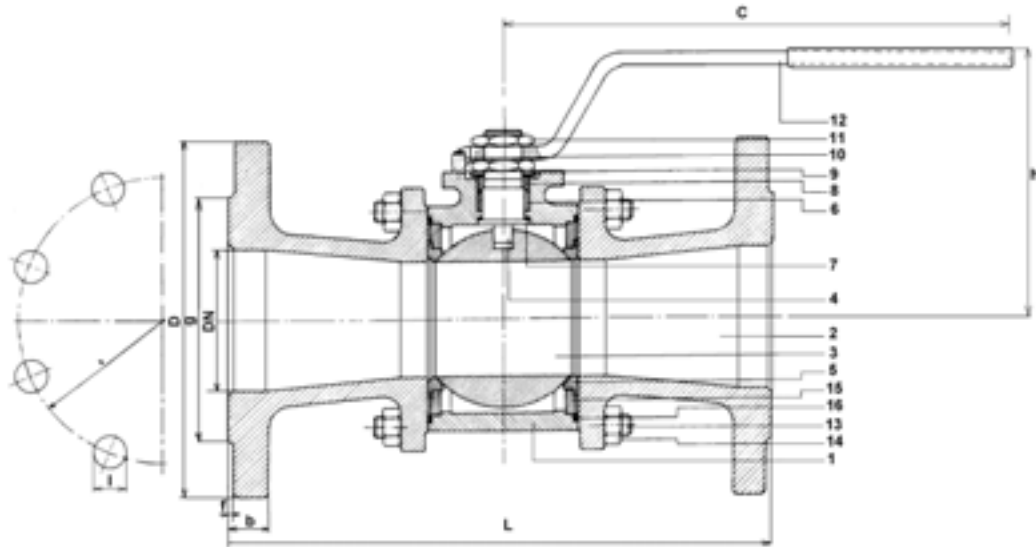

Part no/name	Material	
	PN16	PN40
1-Body	JL1040 (GG-25)	JS1049 (GGG-40.3)
2-End cap	JL1040 (GG-25)	JS1049 (GGG-40.3)
3-Ball	1.4301/1.4086 Stainless steel	1.4301/1.4086 Stainless steel
4-Stem	1.4301 Stainless steel	1.4301 Stainless steel
5-Seat ring	PTFE	PTFE
6-Packing ring	PTFE	PTFE
7-Thrust washer	PTFE	PTFE
8-Packing gland	St.37	St.37
9-Spring washer	Ck70	Ck70
10-Retaining pin	St 37	St 37
11-Handle nut	5	5
12-Handle adaptor	St 42	St 42
13-Stud bolt	5.6	5.6
14-Nut	5	5
15-Support ring	JL 1030 (GG-20)	JL 1030 (GG-20)
16-Body seal	PTFE	PTFE

### REDUCED BORE VALVE DIMENSIONS PN16 – PN40

Size	Dimensions			Flange dimensions														Weight		
	PN 16	PN 40	PN16/40	PN16							PN40							PN16	PN40	
				L	L	h	c	D	b	k	l	n	g	f	D	b	k			l
80/65	310	310	150	285	200	22	160	19	8	132	3	200	24	160	19	8	132	3	20,4	20,8
100/80	350	350	178	410	220	24	180	19	8	156	3	235	24	190	23	8	156	3	31,3	32,6
125/100	325	400	192	410	250	26	210	19	8	184	3	270	26	220	28	8	184	3	43,5	49,6

Dimensions are in mm. We reserve the right to modify construction and material without notice .



- Model** : VKV (Reduced bore)
- Pressure rating** : PN16 – PN25
- Connection** : Flanged to TS ISO 7005-2, DIN EN 1092-2
- Dimensions** : According to EN 558-1
- Applications** : Water, hot water, compressed air, gases, industrial fluids

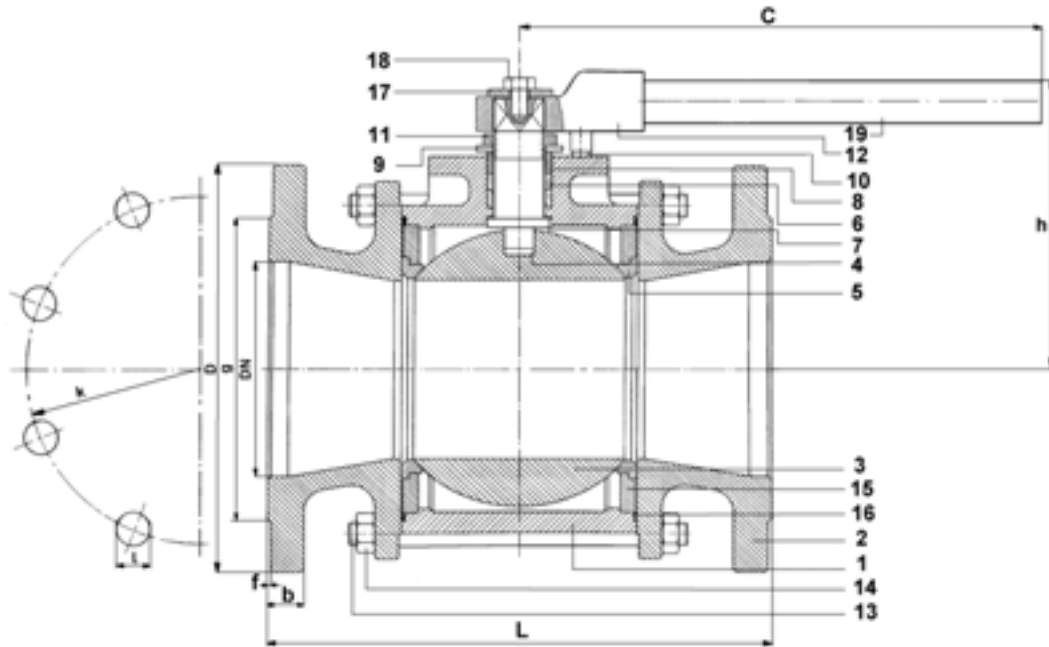

Part no/name	Material	
	PN16	PN25
1-Body	JL1040 (GG-25)	JS1049 (GGG-40.3)
2-End cap	JL1040 (GG-25)	JS1049 (GGG-40.3)
3-Ball	1.4301/1.4086 Stainless steel	1.4301/1.4086 Stainless steel
4-Stem	1.4301 Stainless steel	1.4301 Stainless steel
5-Seat ring	PTFE	PTFE
6-Packing ring	PTFE	PTFE
7-Thrust washer	PTFE	PTFE
8-Packing gland	St.37	St.37
9-Spring washer	Ck70	Ck70
10-Retaining pin	St 37	St 37
11-Handle nut	5	5
12-Handle adaptor	JS 1049 (GGG-40.3)	JS 1049 (GGG-40.3)
13-Stud bolt	5.6	5.6
14-Nut	5	5
15-Support ring	JL 1030 (GG-20)	JL 1030 (GG-20)
16-Body seal	PTFE	PTFE
17-Washer	St 37	St 37
18-Bolt	5.6	5.6
19-Handle	St 42	St 42

**REDUCED BORE VALVE DIMENSIONS PN16 – PN25**

Size	Dimensions				Flange dimensions														Weight	
	PN 16	PN 25	PN16/25	DN	PN16							PN25							PN16	PN25
					L	L	h	c	D	b	k	l	n	g	f	D	b	k		
150/125	350	450	210	660	285	26	240	23	8	211	3	300	28	250	28	8	211	3	62,6	82,7
200/150	400	550	230	695	340	30	295	23	12	266	3	360	30	310	28	12	274	3	94,5	110,7
250/200	450	650	275	905	405	32	355	28	12	319	3	425	32	370	31	12	330	3	178	195

Dimensions are in mm. We reserve the right to modify construction and material without notice .

**Model**  
**Pressure rating**  
**Connection**  
**Dimensions**  
**Applications**

- : VKV (Reduced bore) -Trunnion mounted ball
- : PN16 – PN25
- : Flanged to TS ISO 7005-2, DIN EN 1092-2
- : According to EN 558-1
- : Water, hot water, compressed air, gases, industrial fluids

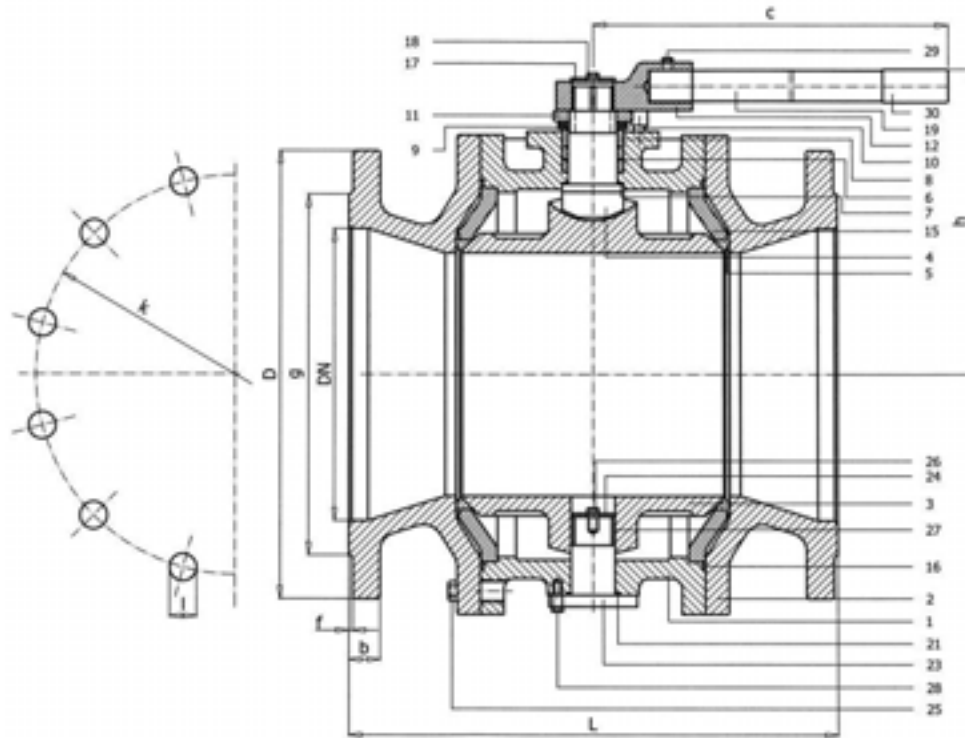

Part no/name	Material	
	PN16	PN25
1-Body	JL1040 (GG-25)	JS1049 (GGG40.3)
2-End cap	JL1040 (GG-25)	JS1049 (GGG40.3)
3-Ball	1.4086 SS	1.4086 SS
4-Stem	1.4104 SS	1.4104 SS
5-Seat ring	PTFE	PTFE
6-Packing ring	PTFE	PTFE
7-Thrust washer	PTFE	PTFE
8-Packing ring	St.37	St.37
9-Spring washer	Ck70	Ck70
10-Retaining pin	St 37	St 37
11-Handle nut	5	5
12-Handle adaptor	JS1049 (GGG40.3)	JS1049 (GGG40.3)
13-Stud bolt	5.6	5.6
14-Nut	5	5
15-Support ring	JL 1030 (GG-20)	JL 1030 (GG-20)
16-Body seal	PTFE	PTFE
17-Washer	St 37	St 37
18-Bolt	5.6	5.6
19-Lever	St 42	St 42
21-Gasket	Grafit	Grafit
23-Lower bearing stem	St42	St42
24-Washer	St37	St37
25-Bolt	8.8	8.8
26-Bolt	5.6	5.6
27-Sleeve ring	R-PTFE	R-PTFE
28-Bolt	5.6	5.6
29-Bolt	8.8	8.8
30-Handle cover	PVC	PVC

Dimensions are in mm.  
 We reserve the right to modify construction and material without notice .

### REDUCED BORE VALVE DIMENSIONS PN16

Size	Dimensions			Flange dimensions						Weight	
	DN	L	h	c	D	b	k	l	n		g
300/250	500	315	1060	460	32	355	28	12	370	4	251

### REDUCED BORE VALVE DIMENSIONS PN25

Size	Dimensions			Flange dimensions						Weight	
	DN	L	h	c	D	b	k	l	n		g
300/250	750	315	1060	485	34	430	31	16	389	4	286

- Model** : VKVm (Full bore & Reduced bore)
- Pressure rating** : PN16/40
- Connection** : Female BSP screwed to EN ISO 228-1
- Dimensions** : According to DIN 3202 - M3
- Applications** : Water, hot water, compressed air, gases, industrial fluids

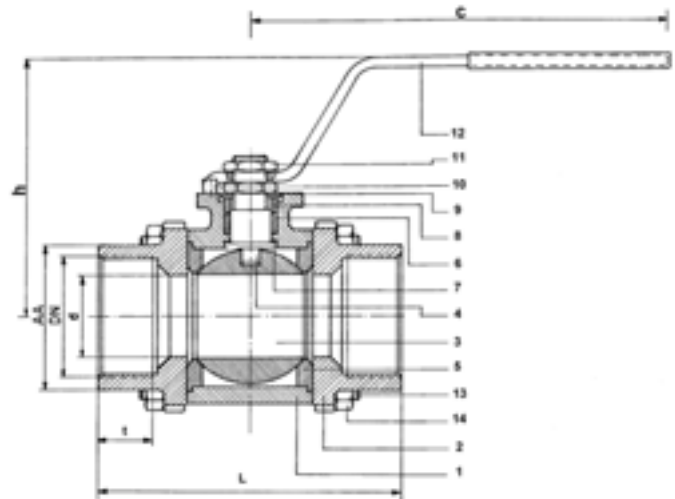
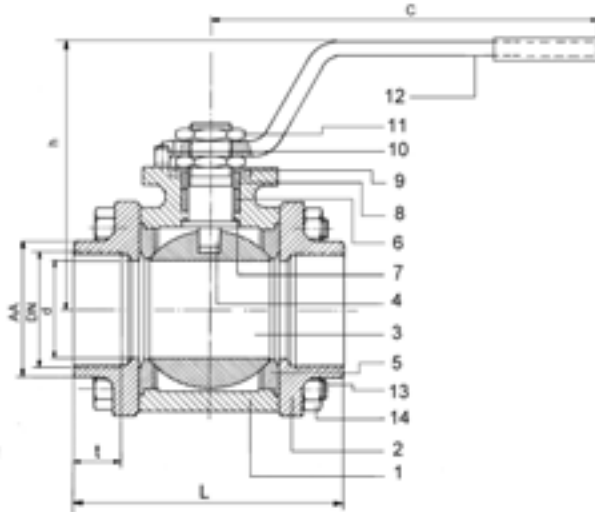

### FULL BORE VALVE DIMENSIONS PN40

Size	Dimensions			Connection dim.			Weight
				PN40			PN40
DN	L	h	c	AA	d	t	Kg
1/2"	75	81	135	27	15	15	0,75
3/4"	80	95	160	32	20	16	1,2
1"	90	100	160	41	25	19	1,6
1 1/4"	110	128	200	50	32	21	2,7
1 1/2"	120	135	200	56	40	21	3,8
2"	140	139	285	70	50	25	6,6

### REDUCED BORE VALVE DIMENSIONS PN40

Size	Dimensions			Connection dim.			Weight
				PN40			PN40
DN	L	h	c	AA	d	t	Kg
1/2"/15	75	81	135	27	15	15	0,65
3/4"/15	80	81	135	32	15	16	0,75
1"/20	90	95	160	41	20	19	1,15
1 1/4"/25	110	100	160	49	25	21	1,65
1 1/2"/32	120	128	200	55	32	21	2,40
2"/40	140	135	200	70	40	25	3,80
2 1/2"/50	150	139	285	90	50	27	7,10

Part no/name	Material
	PN40
1-Body	JS1049 (GGG-40.3)
2-End cap	JS1049 (GGG-40.3)
3-Ball	1.4301/1.4086 SS
4-Stem	1.4104 SS
5-Seat ring	PTFE
6-Packing ring	PTFE
7-Thrust washer	PTFE
8-Packing ring	St.37
9-Spring washer	Ck70
10-Retaining pin	St 37
11-Handle nut	5
12-Handle adaptor	St 42
13-Stud bolt	5.6
14-Nut	5

Dimensions are in mm. We reserve the right to modify construction and material without notice .

**PRESSURE – TEMPERATURE DIAGRAM**

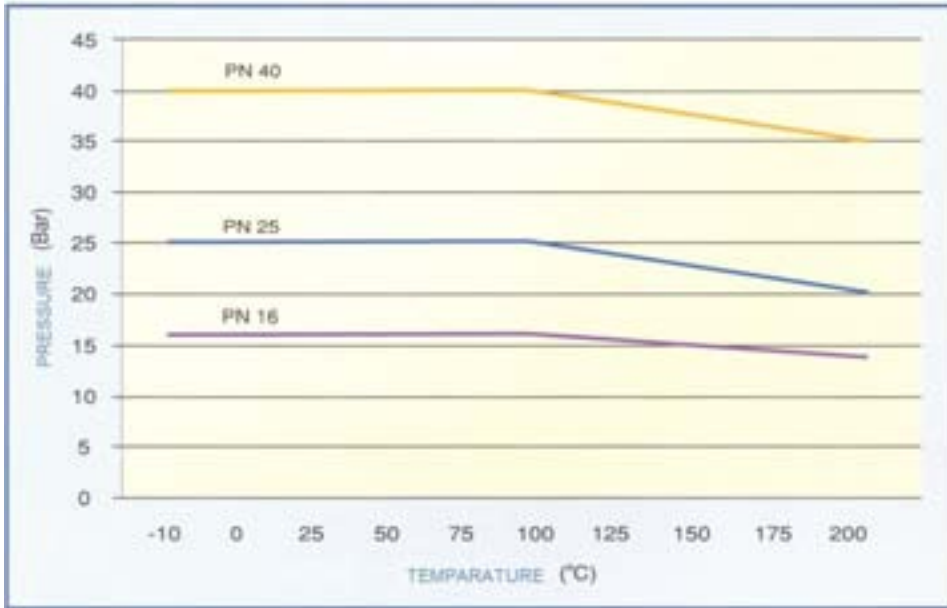

The values in the diagram belong to standard PTFE rings and max. allowable temperature of ball valves depends on temperature limitation of sealing rings. Whenever the specified values are exceeded, deformation occurred on the rings may effect sealing of the valve in a negative way.

Depending on working conditions, fluid characteristics and other conditions, Valftek ball valves can be provided with glass fiber or graphite reinforced PTFE or UHMW sealing rings.

**Operating torque values (N/m)**

DN	15	20	25	32	40	50	65	80	100	125	150	200	250	300
Full bore	5	7	11	14	17	25	45	80	120	210	260	400	560	-
Red. bore	5	5	7	11	14	17	25	45	80	120	210	260	400	560

- ❖ Torque values may vary according to fluid type, temperature, pressure and other fluid characteristics.
- ❖ For dry gases, viscous or abrasive fluids, these values shall increase by 35%.
- ❖ Torque values may decrease by 15% for lubricating fluids such as oils.

**TOP FLANGE DIMENSIONS**

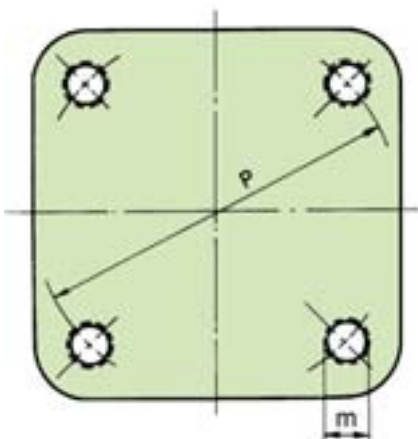

Valve size (DN)		ISO 5211	Top flange connection dimensions		
RG	TG	No	P	m	No
20/15	15	F03	42	M5	4
25/20	20	F04	42	M5	4
32/25	25	F04	42	M5	4
40/32	32	F05	50	M6	4
50/40	40	F05	50	M6	4
65/50	50	F07	70	M8	4
80/65	65	F07	70	M8	4
100/80	80	F10	102	M10	4
125/100	100	F10	102	M10	4
150/125	125	F12	125	M12	4
200/150	150	F12	125	M12	4
250/200	200	F12	125	M12	4
300/250	250	F14	140	M16	4

Dimensions are in mm.

DIN-ANSI Flange Dimensions

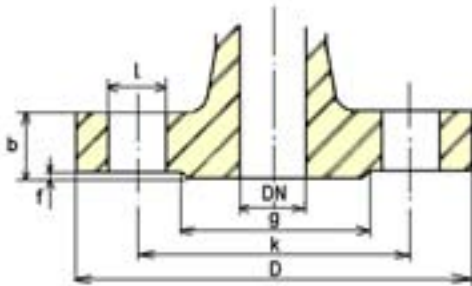

PN	DN	D	b	g	f	Nº	l	k
6 (DIN)	15	80	12	38	2	4	11	55
10-16 (DIN)	15	95	14	46	2	4	14	65
150 (ANSI)	1/2"	88,9	11,1	34,9	1,6	4	15	60,3
25-40 (DIN)	15	95	14	46	2	4	14	65
300 (ANSI)	1/2"	95,2	14,3	34,9	1,6	4	15	66,7
600 (ANSI)	1/2"	95,2	20,65	34,9	6,35	4	25	66,7
64-100 (DIN)	15	105	20	45	2	4	14	75
900-1500 (ANSI)	1/2"	121	28,55	34,9	6,35	4	23	82,5
6 (DIN)	20	90	14	48	2	4	11	65
10-16 (DIN)	20	105	16	56	2	4	14	75
150 (ANSI)	3/4"	98,4	11,1	42,9	1,6	4	15	69,8
25-40 (DIN)	20	105	16	56	2	4	14	75
300 (ANSI)	3/4"	118	15,9	42,9	1,6	4	18	82,5
600 (ANSI)	3/4"	118	22,25	42,9	6,35	4	18	82,5
64-100 (DIN)	20	130	22	58	2	4	18	90
900-1500 (ANSI)	3/4"	130	31,75	42,9	6,35	4	23	88,9
6 (DIN)	25	100	14	58	3	4	11	75
10-16 (DIN)	25	115	16	65	3	4	14	85
150 (ANSI)	1"	108	11,1	50,8	1,6	4	15	79,4
25-40 (DIN)	25	115	16	65	3	4	14	85
300 (ANSI)	1"	124	17,55	68	1,6	4	18	88,9
600 (ANSI)	1"	124	23,85	50,8	6,35	4	18	88,9
64-100 (DIN)	25	140	24	68	2	4	18	100
900-1500 (ANSI)	1"	149	34,95	50,8	6,35	4	26	102
6 (DIN)	32	120	16	69	3	4	14	90
10-16 (DIN)	32	140	18	76	3	4	19	100
150 (ANSI)	1 1/4"	118	12,7	63,5	1,6	4	15	88,9
25-40 (DIN)	32	140	18	76	3	4	19	100
300 (ANSI)	1 1/4"	133	19	63,5	1,6	4	18	98,4
600 (ANSI)	1 1/4"	133	26,95	63,5	6,35	4	18	98,4
64-100 (DIN)	32	155	26	78	2	4	22	110
900-1500 (ANSI)	1 1/4"	159	34,95	63,5	6,35	4	26	111
6 (DIN)	40	130	16	78	3	4	14	100
10-16 (DIN)	40	150	18	84	3	4	19	110
150 (ANSI)	1 1/2"	127	14,3	73	1,6	4	15	98,4
25-40 (DIN)	40	150	18	84	3	4	19	110
300 (ANSI)	1 1/2"	156	20,6	73	1,6	4	23	114
600 (ANSI)	1 1/2"	156	28,55	73	6,35	4	23	114
64-100 (DIN)	40	170	28	88	2	4	22	125
900-1500 (ANSI)	1 1/2"	178	38,05	73	6,35	4	30	124
6 (DIN)	50	140	16	88	3	4	14	110
10-16 (DIN)	50	165	20	99	3	4	19	125
150 (ANSI)	2"	152	15,9	92,1	1,6	4	18	121
25-40 (DIN)	50	165	20	99	3	4	19	125
300 (ANSI)	2"	165	22,2	92,1	1,6	8	18	127
64 (DIN)		180	26	102	2	4	22	135
600 (ANSI)	2"	165	31,75	92,1	6,35	8	18	127
100 (DIN)	50	195	30	102	3	4	26	145
900-1500 (ANSI)	2"	216	44,45	92,1	6,35	8	26	165

PN	DN	D	b	g	f	Nº	l	k
6 (DIN)	65	160	16	108	3	4	14	130
10-16 (DIN)	65	185	20	118	3	4	19	145
150 (ANSI)	2 1/2"	178	17,5	105	1,6	4	18	140
25-40 (DIN)	65	185	22	118	3	8	19	145
300 (ANSI)	2 1/2"	191	25,4	105	1,6	8	23	149
64 (DIN)		205	26	122	2	8	22	160
600 (ANSI)	2 1/2"	191	34,95	105	6,35	8	23	149
100 (DIN)	65	220	34	122	2	8	26	170
900-1500 (ANSI)	2 1/2"	245	47,65	105	6,35	8	30	191
6 (DIN)	80	190	18	124	3	4	19	150
10 (DIN)	80	200	22	132	3	8	19	160
16 (DIN)	80	200	22	132	3	8	19	160
150 (ANSI)	3"	191	19	127	1,6	4	18	152
25-40 (DIN)	80	200	24	132	3	8	19	160
300 (ANSI)	3"	210	28,6	127	1,6	8	23	168
64 (DIN)		215	28	138	2	8	22	170
600 (ANSI)	3"	210	38,05	127	6,35	8	23	168
100 (DIN)	80	230	36	138	2	8	26	180
900 (ANSI)	3"	241	44,45	127	6,35	8	26	191
6 (DIN)	100	210	18	144	3	4	19	170
10-16 (DIN)	100	220	24	156	3	8	19	180
150 (ANSI)	4"	229	23,8	157	1,6	8	18	191
25-40 (DIN)	100	235	24	156	3	8	23	190
300 (ANSI)	4"	254	31,7	157	1,6	8	23	200
64 (DIN)	100	250	30	162	2	8	26	200
600 (ANSI)	4"	273	44,45	157	6,35	8	26	216
100 (DIN)	100	265	40	162	2	8	30	210
900 (ANSI)	4"	292	50,75	157	6,35	8	33	235
6 (DIN)	125	240	20	174	3	8	19	200
10-16 (DIN)	125	250	26	184	3	8	19	210
150 (ANSI)	5"	254	23,8	186	1,6	8	23	216
25-40 (DIN)	125	270	26	184	3	8	28	220
300 (ANSI)	5"	279	34,9	186	1,6	8	23	235
64 (DIN)	125	295	34	188	2	8	30	240
600 (ANSI)	5"	330	50,75	186	6,35	8	28	267
100 (DIN)	125	315	40	188	2	8	33	250
900 (ANSI)	5"	349	57,15	186	6,35	8	36	279
6 (DIN)	150	265	20	199	3	8	19	225
10-16 (DIN)	150	285	26	211	3	8	23	240
150 (ANSI)	6"	279	25,4	216	1,6	8	23	241
25-40 (DIN)	150	300	28	211	3	8	28	250
300 (ANSI)	6"	318	36,5	216	1,6	12	23	270
64 (DIN)	150	345	36	218	2	8	33	280
600 (ANSI)	6"	356	53,95	216	6,35	12	30	292
100 (DIN)	150	355	44	218	2	12	33	290
900 (ANSI)	6"	381	61,95	216	6,35	12	33	318
6 (DIN)	200	320	22	254	3	8	19	280
10 (DIN)	200	340	26	266	3	8	23	295
16 (DIN)	200	340	30	266	3	12	23	295
150 (ANSI)	8"	343	28,6	270	1,6	8	23	298
25 (DIN)	200	360	30	274	3	12	28	310
40 (DIN)	200	375	34	284	3	12	31	320
300 (ANSI)	8"	381	41,3	270	3	12	26	330
64 (DIN)	200	415	42	285	2	12	36	345
600 (ANSI)	8"	419	61,95	270	3	12	33	349
100 (DIN)	200	430	52	285	2	12	36	360
900 (ANSI)	8"	470	69,85	270	3	12	39	394

Dimensions are in mm.

**Other Ball Valve Applications And Accessories**

- ❖ **SHORT PATTERN BALL VALVES PN6-10 (Full bore)**
- ❖ **BALL VALVES FOR NATURAL GAS / LPG**
- ❖ **ACTUATED BALL VALVES**
- ❖ **BALL VALVES WITH EXTENSION STEMS**
- ❖ **BALL VALVES FOR FIRE FIGHTING**
- ❖ **SPECIAL APPLICATIONS**

